

Non-Rising Stem, Inside Bonnet, Solid Wedge Disc, Flange Type

Construction Specification

Size:	2"-12"
Design Std:	MSS SP-70
Face to Face:	ANSI B16.10
Flange Drilling:	ANSI B16.1
	Other flange drilling special, is available on customers' request.

Application Specification

Size (DN)	Pressure Rating (PN)	Hydro-Test Prssure		Suitable Medium
		Body	Seat	
40-200	16	2.4 Mpa	1.6 MPa	Water, Oil, Steam
40-300	10	1.5 MPa	1.0 MPa	

The valve is closed by turning the stem in clockwise direction. Underground installation set available on request. Gear Box Operator or Wrench Head is available on customers' Requirement.

Not recommended for Steam Service.

Caution: FREEZING WEATHER PRECAUTION - Subsequent to testing a piping system, gate valves should be left in an open position to allow complete drainage

Materials List

No	Part Name	Material	
1	Body	ASTM A126A(B)	GG20 GG25
2	Seat Ring	ASTM B36/B62,SS410	Brass,Bronze
3	Wedge Ring	ASTM B36	Brass
4	Wedge	ASTM A126A(B)	GG20 GG25
5	Wedge Nut	ASTM B36	Brass
6	Bolt	A216 WCB	GS-C25
7	Nut	A216 WCB	GS-C25
8	Washer	A216 WCB	GS-C25
9	Bonnet Gasket	Graphite	Graphite
10	Nut	ASTM B36	Brass
11	Half Ring	A216 WCB	GS-C25
12	Packing	Graphite	Graphite
13	Bonnet	ASTM A126A(B)	GG20 GG25
14	Gland	ASTM B36	Brass
15	Stem	SS410	X10Cr13
16	Handwheel	ASTM A126B	GG25
17	Washer	A216 WCB	GS-C25
18	Bolt	A216 WCB	GS-C25

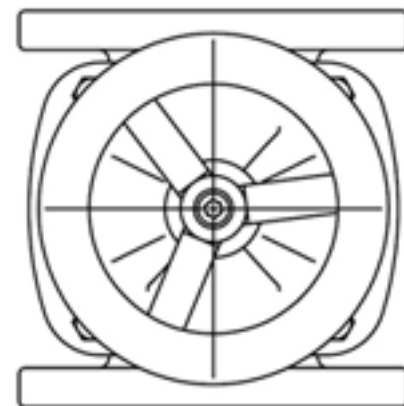

When placing the order, please specify Working Pressure, Working Temperature, Flange Drilling Etc;

Fig.Z4503

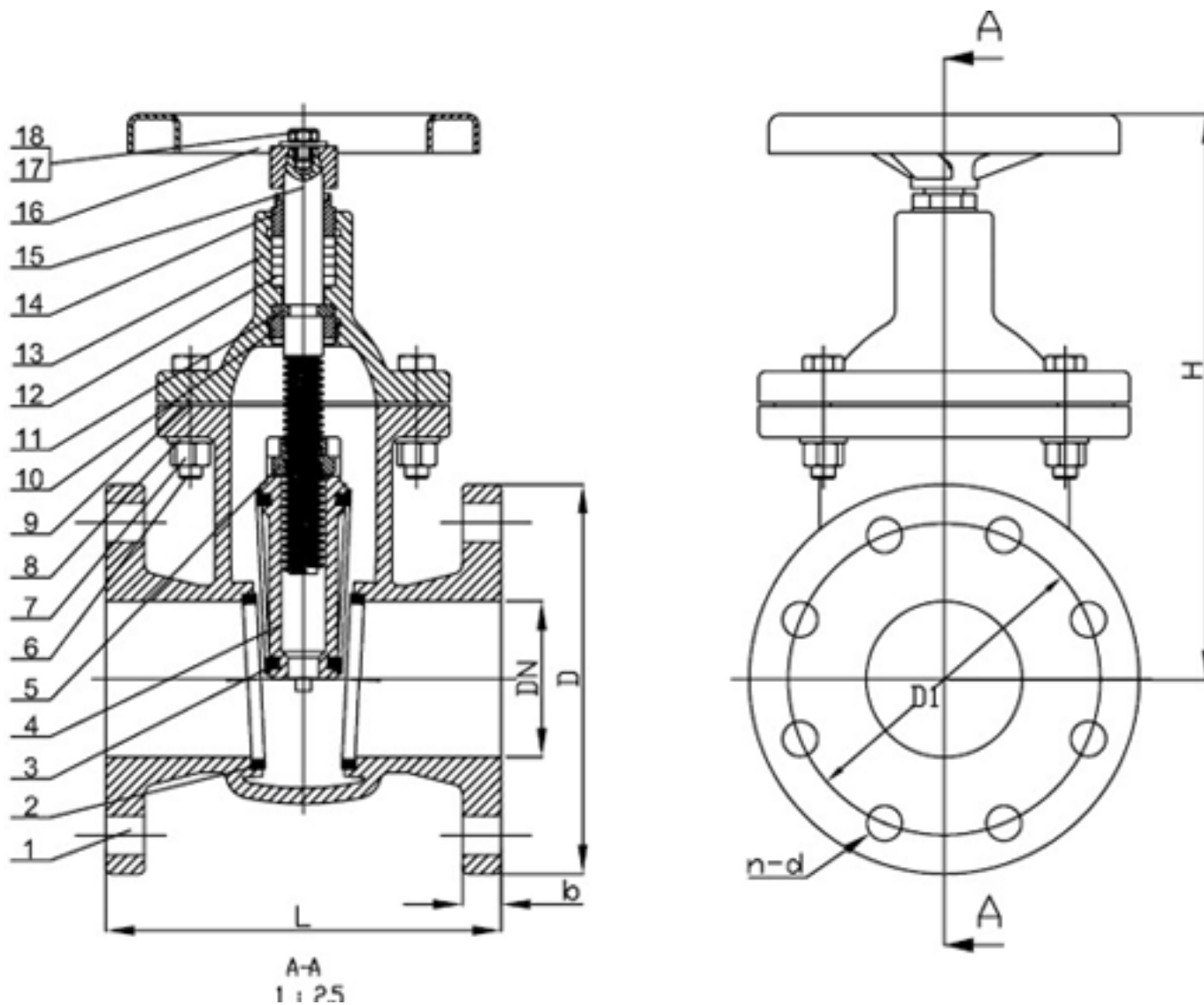

Dimensions List

DN	D	D1	L	H	b	n	d	Wg
2"	152	120.7	177.8	250	15.8	4	19	13.5
2.5"	178	139.7	190.5	265	17.5	4	19	17.8
3"	191	152.4	203.2	300	19	4	19	22.2
4"	229	190.5	228.6	350	23.9	8	19	29.8
5"	254	215.9	254	410	23.9	8	22	43.7
6"	279	241.3	266.7	450	25.4	8	22	56.81
8"	343	298.5	292.1	550	28.5	8	22	80.9
10"	406	362	330.2	650	30.2	12	25	129.9
12"	483	431.8	355.6	710	31.8	12	25	171.8