

Nominal pressure	PN10	PN16
Test pressure	Strength test	PN15
	Sealing test	PN11
Maximum working temperature	-20 °C to +110 °C	
Suitable Media	W.O.G etc	

Part name	Material
Body	Cast Iron / WCB
Disc	SS 316
Stem	SS 410
seat	NBR/EPDM
Operator	Worm Gear
Top Flange Drilling Standard	ISO 5211
DN40 - DN300 Rating	PN16
DN40-DN600 Rating	PN10

Size	L	ANSI 150		DIN2533		ØD2	H1	H2	H3	-0.02 Øc-0.07	ØE	ØE1	4-Ød0
		ØD1	n-Ød1	ØD1	n-Ød1								
DN40	32	98.5	4-16	110	4-18	42	68	139	32	12.6	65	50	4-8
DN50	42.04	120.6	4-19	125	4-18	52.5	80	161	32	12.6	65	50	4-8
DN65	44.68	139.7	4-19	145	4-18	63.8	89	175	32	12.6	65	50	4-8
DN80	45.21	152.4	4-19	160	8-18	78.1	95	181	32	12.6	65	50	4-8
DN100	52	190.5	8-19	180	8-18	103.8	114	200	32	15.77	90	70	4-10
DN125	54.36	215.9	8-22.4	210	8-18	123.1	127	213	32	18.92	90	70	4-10
DN150	55.7	241.3	8-22.4	240	8-22	155	139	226	32	18.92	90	70	4-10
DN200	60.1	298.4	8-22.4	295	12-22	202.1	175	260	40	22.1	125	102	4-12
DN250	65.63	361.9	12-25.4	355	12-26	250.1	203	292	40	28.45	125	102	4-12
DN300	76.5	431.8	12-25.4	410	12-26	301.1	242	337	40	31.60	125	102	4-12
DN350	76	476.2	12-28.4	470	16-26	333.3	267	368	45	31.60	125	102	4-12
DN400	86	539.7	16-28.4	525	16-30	389.6	297	400	51.2	33.15	175	140	4-18
DN450	105	577.8	16-31.8	585	20-30	440.5	318	422	51.2	38	175	140	4-18
DN500	127	635.0	20-31.8	650	20-33	491.6	348	480	64.2	41.15	175	140	4-18
DN600	151	749.3	20-35.1	770	20-36	592.5	444	562	64.2	50.65	210	165	4-22

1. Design and manufacture according to API 609.
2. Face to face according to API 609.
3. Flange drilling according to ANSI 150/DIN2533 PN16
4. Top flange drilling according to ISO 5211.
5. Pressure test according to API598.

zh		HuiHua Valve Industry Co.	
Pressure	PN16 /PN10	Name	Butterfly Valve
Size	DN40-DN600	Operator	Worm gear
Date		Drawing No.	NO.1
		Fig.	B1000W

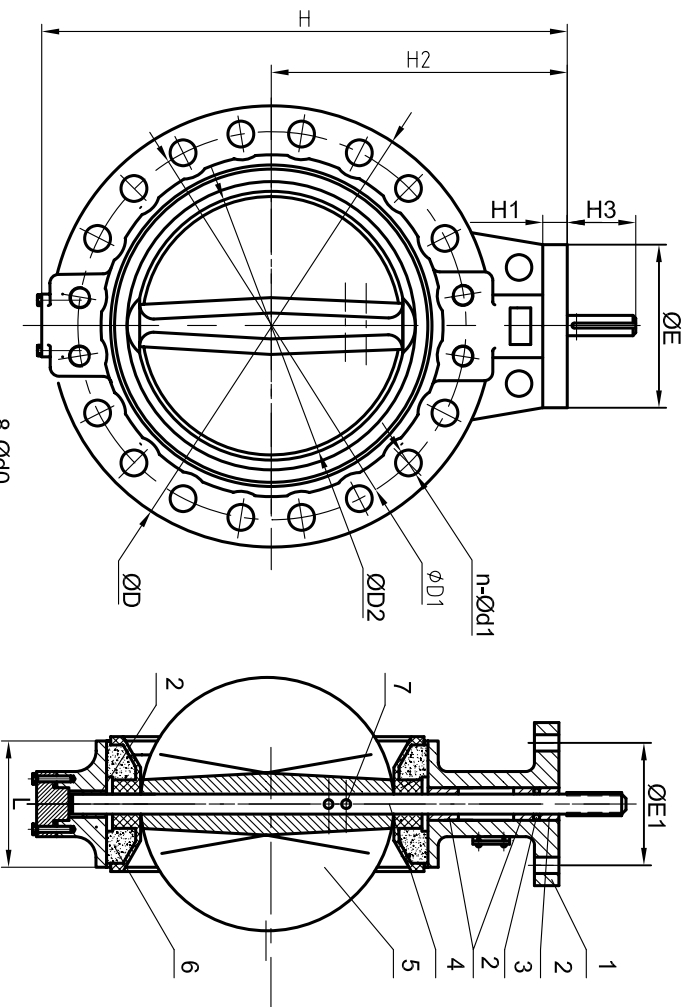

Nominal pressure		PN 10
Test pressure	Strength test	PN 15
	Sealing test	PN 11
Maximum working temperature		-20 °C to +110 °C
Suitable Media		W.O.G etc

No.	Item	Quantity	Material
1、	BODY	1	Cast Iron/WCB
2、	BUSHING	4	PTFE
3、	"O" RING	1	NBR
4、	STEM	1	SS 410
5、	DISC	1	SS 316
6、	SEAT	1	NBR / EPDM
7	PIN	3	SS 410

Size	L	H1	H2	H3	ANSI 150		DIN2533 PN16		ØD2	ØE	Ø E1	8 - Ød1
					ØD1	n-Ød1	ØD1	n-Ød1				
700	162	33	623.9	66/82	863.6	28-35.1	840	24-36	695	300	254	8-18
750	166	33	646	66/82	914.4	28-35.1	900	24-39	744.6	300	254	8-18
800	187	35	672	66/82	977.9	28-41.1	950	28-39	794.7	300	254	8-18
900	202	35	720	118	1085.8	32-41.1	1050	28-39	864.7	300	254	8-18
1000	215	35	800	142	1200.2	38-41.1	1170	28-42	965	300	254	8-18
1200	276	35	940.7	160	1422.4	44-41.1	1390	32-48	1165	350	298	8-22

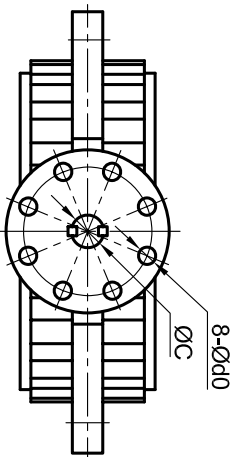

- 1.Design and manufacture according to API 609.
- 2.Face to face according to API 609.
- 3.Flange drilling according to ANSI 150,DIN2533
- 4.Top flange drilling according to ISO 5211.
- 5.Pressure test according to API598.



HuiHua Valve Industry Co.

Pressure	PN10	Name	Butterfly Valve		
Size	DN700-DN1200	Operator	lever	Fig.	B1000W
Da		Drawing	NO. 2		